

RJ45 PLUG DUST CAP

DESCRIPTION

Designed to provide effective protection, the Dust Caps for RJ45 Plugs prevent dust and moisture from infiltrating, preserving the integrity and performance of the connections. With a precise and secure fit, these caps are essential in environments where RJ45 ports are temporarily unused, ensuring the longevity and reliability of the network.

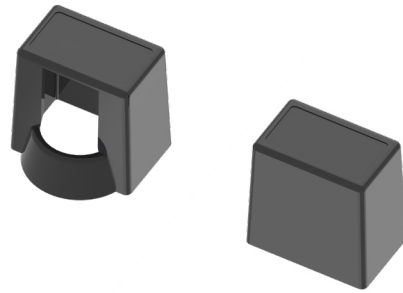

APPLICABLE STANDARDS

• Directive 2011/65/EU (RoHS)

MECHANICAL AND PHYSICAL SPECIFICATIONS

Material	PC
Color	Black (RAL 9004)
Compatibility	RJ45 Plugs
Weight (kg)	0,0007
Dimensions (mm)	14,0 x 14,2 x 12,9

LOGISTICS INFORMATION

Code	PLA Bag			Inner Box			Outer Box		
	Quantity (un)	Weight (kg)	Dimensions (mm)	Quantity (un)	Weight (kg)	Dimensions (mm)	Quantity (un)	Weight (kg)	Dimensions (mm)
82240901000	50	0,004	160x150	1500	1,57	450x300x150	9000	11,51	650x500x500

TECHNICAL DRAWING (mm)

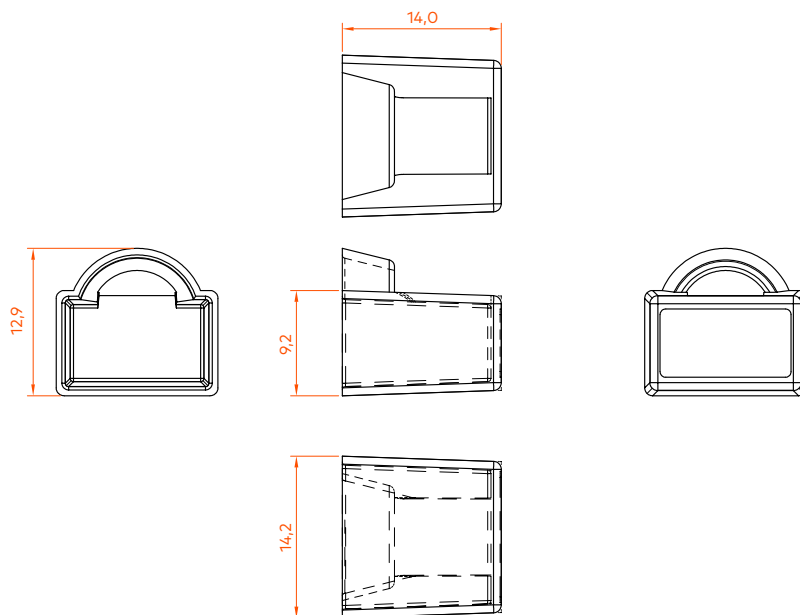

PACKAGING

This images are merely illustratives. We want you to see the importance we attach to the packaging.
We always work with products and materials that are easy to use.

